

## Vehicle digital radio stereo system

DAB Radio/FM Radio/Bluetooth/TF card & USB disk MP3



MODEL: DR-9

## INSTRUCTION MANUAL



## BEFORE USE

### IMPORTANT

- To ensure proper use, please read through this manual before using this product. It is especially important that you read and observe Warning and Caution in this manual.
- Please keep the manual in a safe and accessible place for future reference.

### ▲ Warning

Do not operate any function that takes your attention away from safe driving.

### ▲ Caution

Volume setting:

- Adjust the volume so that you can hear sounds outside the car to prevent accidents.
- Lower the volume before playing digital sources to avoid damaging the speakers by the sudden increase of the output level.

General:

- Avoid using the external device if it might hinder safe driving.
- Make sure all important data has been backed up. We shall bear no responsibility for any loss of recorded data.
- Never put or leave any metallic objects (such as coins or metal tools) inside the unit to prevent a short circuit.



## BASICS

Faceplate

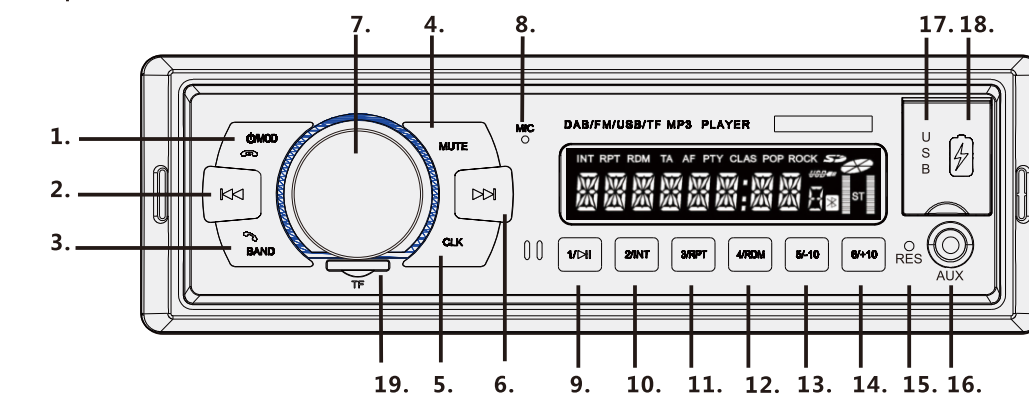

- Power turn ON/OFF, Mode selected, Hang up
- Station or track previous
- DAB/FM full scan, FM band selected, call answer
- Mute ON/OFF
- Clock show, clock setting
- Stations or track next
- Volume adjust, EQ/Balance setup
- Microphone
- Preset address 1, Play/Pause
- Preset address 2, songs preview play
- Preset address 3, single repeat
- Preset address 4, random play
- preset address 5, playing -10 in list
- preset address 6, playing +10 in list
- System reset
- Auxiliary input jack
- USB disk input
- Micro-SD(TF card) input

## WIRING CONNECTION

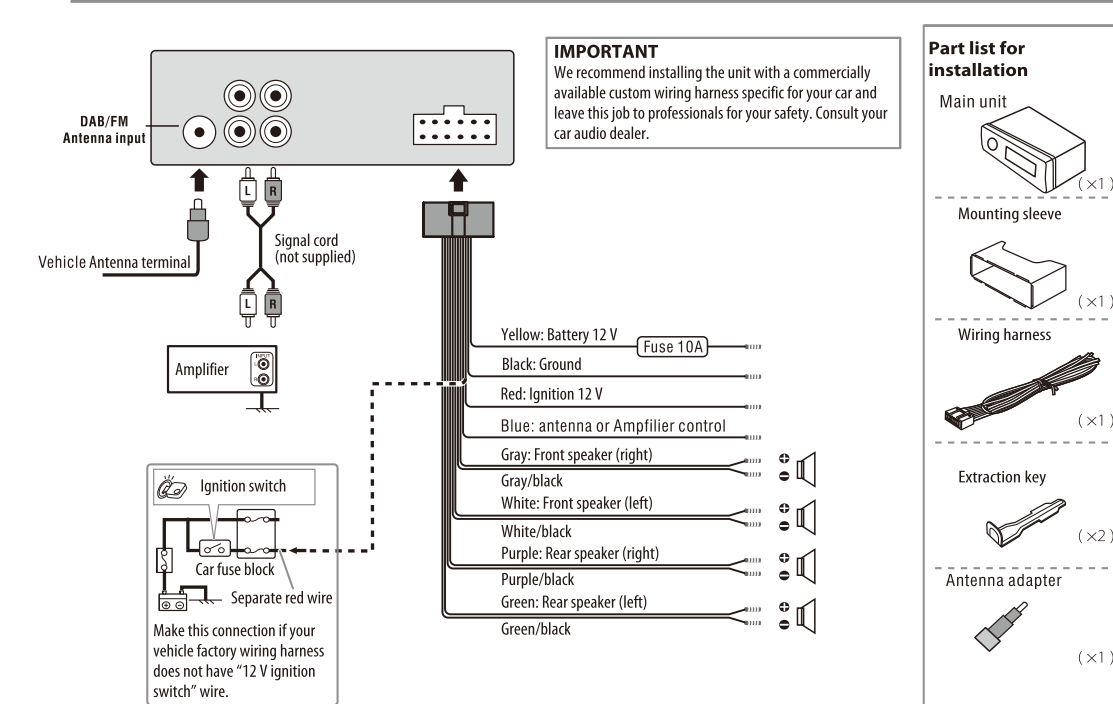

## GETTING STARTED

### 1 Turn ON/OFF the radio

- When the radio is OFF, press **MOD** to power ON
- When the radio is ON, press and hold **MOD** to power OFF

### 2 Set the clock

- Press and hold **CLK**, the hour number is flash, turn knob adjust the number, press knob to confirm, then minute number is flash, turn knob to adjust the number, press knob to confirm
- When the DAB is work, the clock time will automatically set using the clock time date in DAB signal

## FM RADIO

### 1 Scan the FM radio stations

- In FM mode, press and hold **[BAND]** to search all FM stations
- In FM mode, press **[<=>]** to search previous or next FM station
- In FM mode, press and hold **[<=>]**, screen display "manual" enter manual search mode, turn knob scan by 0.05MHz step. It will return to the auto scan mode after a few seconds without any operation, screen display "AUTO"

### 2 Set preset FM stations

- When search all FM stations, the stations automatically stored to the preset address(1-6 number), there is 3 bands 18 addresses in total, each band can store 6 addresses
- When the playing station is not a preset station, press and hold 1-6 number to store.

### 3 Preset stations recall

In FM mode, press **[BAND]** to select the stored preset stations to select the stored preset stations

## DAB RADIO

### 1 Scan the DAB radio stations

- In DAB mode, press and hold **[BAND]** to search all DAB stations, the screen display "SCAN: 00", "SCAN" is flash in searching, when finished searching, screen display "TOTAL: number".
- In DAB mode, press **[<=>]** to select previous or next stations
- Usually the screen display the DAB station name such as "BBC NEWS", press **[BAND]** to check station number and total number "CH01/34"
- Screen display "NO STA" it mean no DAB stations have been searched screen display "NO SER" it mean the playing station signal is too weak or missing

### 2 Set preset DAB stations

When the playing station is not a preset station, press and hold 1-6 number to store as a new preset station. If the number have been stored it will be replaced

### 3 Preset stations recall

In DAB mode, press **[1-6 number]** to select the stored preset stations. If the number have not been stored any station, screen display "PRE N/A"

## BLUETOOTH

### 1 Connect to the smart phone

In any mode, use smart phone bluetooth to search "DAB-CAR" to connect

### 2 Bluetooth calling hands-free

- In any mode, when use the phone calling, screen will display "CALL IN, CALL OUT, TALKING"
- When calling, press **[<=>]** to answer, press **[<=>]** to hang up.

### 3 Bluetooth streaming playback

In BT mode, when use smart phone play music, screen display "BT PLAY" you can operate **[<=>]** **[>]** to previous/next/pause, screen will display "BT PREV" "BT NEXT" "BT PAUSE"

## USB disk/TF card playback

### Start playback

The source changes automatically and playback start when insert USB disk or TF card

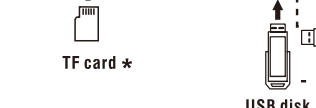
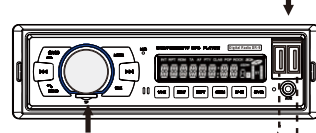
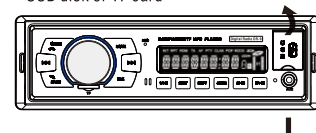

TF card \*  
USB disk  
Charger to mobile-phone

### How to control

- [<=>]** to previous/next songs
- [>]** to play/pause songs
- [INT]** to preview all songs
- [RPT]** to repeat single song
- [RDM]** to random play in list
- [-10]** to play previous 10 song in list
- [+10]** to play next 10 song in list

**NOTE:** If you want to remove the TF card, please stop playing and switch to other mode, otherwise the unit will crash need to reset.

## AUX

### Use a portable audio player

3.5 mm (1/8") stereo mini plug with "L" shaped connector (commercially available)

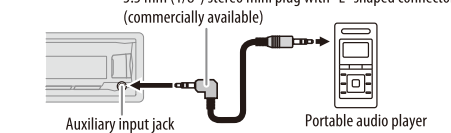

Press **[MOD]** repeatedly to select AUX, turn on the portable audio player or smart phone and start playback

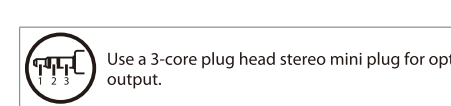

Use a 3-core plug head stereo mini plug for optimum audio output.

## AUDIO SETTINGS

### MUTE ON/OFF

Press **[MUTE]** to turn on/off mute

### FADER AND BALANCE SETTING

Press **[KNOB]** screen display "BAL" turn knob to adjust the left and right speaker output balance, "L07----R07"  
Press **[KNOB]** repeatedly screen display "FAD", turn knob to adjust the front and rear speaker output balance, "R07----F07"

### EQ SETTING

Press **[KNOB]** repeatedly screen display "LOUD", turn knob to turn on/off the loud mode.  
Press **[KNOB]** repeatedly screen display "EQ", turn knob to adjust the EQ mode "ROCK/CLASSIC/POP/OFF" will be selected

## TROUBLESHOOTING

Symptom	Remedy
Screen no display or button not lighter	Check whether the wiring harness is connected correctly
Sound cannot be heard	Adjust the volume to the optimum level Check the cords and connections
Radio reception is poor DAB sound stuck FM static noise	Connect the antenna firmly Add an antenna amplifier
Can not read U-disk or TF card	The U-disk or TF card is damaged, please replace it
Can not read the music file in U-Disk or TF card	The music file format is not support by this unit It only support forms file in specification
Insert U-disk or TF card screen not display	The music file in storage is too much, need some time to read
Antenna connector don't match your car	Use a antenna connector adapter commercially available
Your vehicle power supply is 24V or 36V	Use a power converter commercially available convert your vehicle power supply to 12V
Crash caused by some unknown reason	Please poke the reset hole with a slender object, reset the unit

## INSTALLATION / CONNECTION

### ▲ Warning

- The unit can only be used with a 12 V DC power supply, negative ground.
- Disconnect the battery's negative terminal before wiring and mounting.
- Do not connect Battery wire (yellow) and Ignition wire (red) to the car chassis or Ground wire (black) to prevent a short circuit.
- Insulate unconnected wires with vinyl tape to prevent a short circuit.
- Be sure to ground this unit to the car's chassis again after installation.

### ▲ Caution

- For safety's sake, leave wiring and mounting to professionals. Consult the car audio dealer.
- Install this unit in the console of your vehicle. Do not touch the metal parts of this unit during and shortly after use of the unit. Metal parts such as the heat sink and enclosure become hot.
- Do not connect the  $\ominus$  wires of speakers to the car chassis or Ground wire (black), or connect them in parallel.
- Connect speakers with a maximum power of more than 25 W. If the maximum power of the speakers is lower than 25W, change the speakers
- Mount the unit at an angle of less than 30°.
- If your vehicle wiring harness does not have the ignition terminal, connect ignition wire (red) to the terminal on the vehicle's fuse box which provides 12 V DC power supply and is turned on and off by the ignition key.
- Keep all cables away from heat dissipate metal parts.
- After the unit is installed, check whether the brake lamps, blinkers, wipers, etc. on the car are working properly.
- If the fuse blows, first make sure the wires are not touching car's chassis, then replace the old fuse with one that has the same rating.

### Basic procedure

- Remove the key from the ignition switch, then disconnect the  $\ominus$  terminal of the car battery.
- Connect the wires properly.  
See Wiring connection.
- Install the unit to your car.  
See Installing the unit (in-dash mounting).
- Connect the  $\ominus$  terminal of the car battery.

### Installing the unit (in-dash mounting)

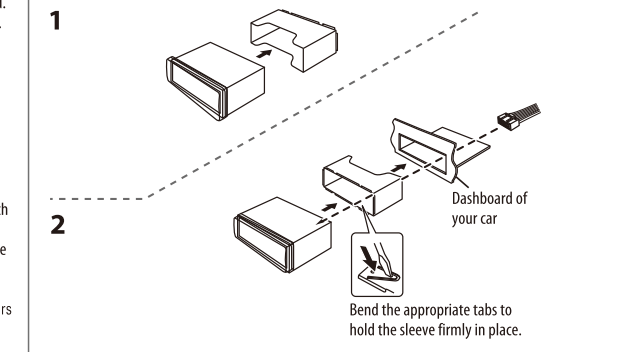

### How to remove the unit

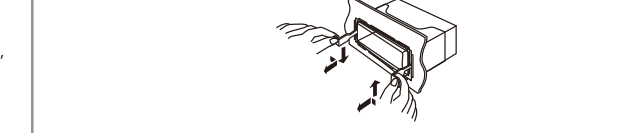

## SPECIFICATIONS

Category	Parameter	Value
Tuner	FM Frequency Range	87.5 MHz — 108.0 MHz (50 kHz step)
	Channel Space Selection	50 kHz
	Usable Sensitivity (S/N = 26 dB)	8.2 dBf (0.71 μV/75 Ω)
	Quieting Sensitivity (DIN S/N = 46 dB)	17.2 dBf (2.0 μV/75 Ω)
	Frequency Response (±3 dB)	30 Hz — 15 kHz
Audio	Signal-to-Noise Ratio (MONO)	64 dB
	Stereo Separation (1 kHz)	40 dB
	Maximum Output Power	25W × 4
	Speaker Impedance	4 Ω — 8 Ω
General	Operating Voltage (10.5 V — 16 V allowable)	14.4 V
	Maximum Current Consumption	10 A
	Operating Temperature Range	-10°C — +60°C
	Installation Size (W × H × D)	182 * 53 * 80mm
USB/TF card	Maximum Supply Current	DC 5 V --- 1 A
	Micro-SD/TF card speed	Full-speed
Bluetooth	Bluetooth version	BT 4.2 Ver
	Bluetooth Name	DAB-CAR

Input Impedance: 30 kΩ  
Preout Level: 2,500 mV/10 kΩ  
Preout Impedance: ≤ 600 Ω

File system: FAT16/32, exFAT/FAT64

Transmission distance: 8-10m

Subject to change without notice.